



PLANNING COMMISSION Memo

Planning Commission Meeting Date: April 14, 2021

TO: Members of the Planning Commission

FROM: Brian Halvorson, Planning Manager
b_halvorson@ci.lompoc.ca.us

RE: **Agenda Item No. 4**
Supplemental Information (Public Comment)

CUP 20-01 – Cannabis Storage Containers and Consideration of Approval of Addendum to the EIR for the Central Coast Business Park Specific Plan

Staff recommends that the attached Landscape Plans be incorporated into the Planning Commission plan set received in the Planning Commission Packet and the complete set be considered for approval for this project.

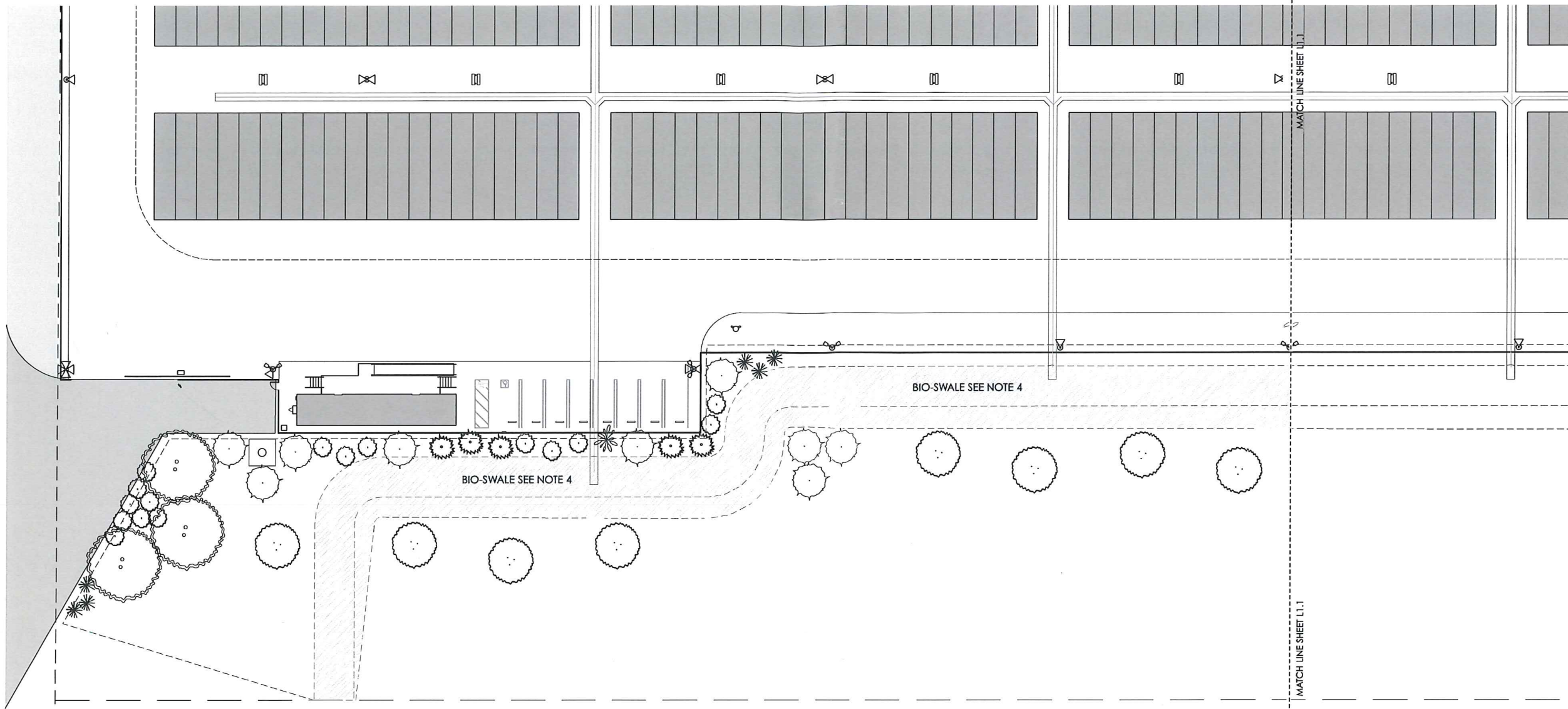

PLANTING PLAN

SCALE: 1" = 20'-0"



CONSTRUCTION DOCUMENTS

No.	Revision	Date	By

PROPOSED PLANT PALLET

**CENTRAL COAST
DRY COASTAL CALIFORNIA
DROUGHT TOLERANT PLANTINGS**

SYMBOL	BOTANICAL NAME COMMON NAME	PLANT TYPE QUANTITY	QUANTITY CONTAINER SIZE
	HETEROMELES ARBUTIFOLIA CALIFORNIA TOYON	SCREEN SHRUB	8/15 GALLON
	CEANOETHUS 'CONCHA' CALIFORNIA LIAC	MEDIUM SHRUB	9/5 GALLON
	ARCTOSTAPHYLOS HOOKERI MONTEREY MANZANITA	MEDIUM SHRUB	5/1 GALLON
	FESTUCA MARIE ATLAS FESCUE	ORNAMENTAL GRASS	6/1 GALLON
	LANTANA MONTEVIDENSIS PURPLE LANTANA	LOW SHRUB	16/1 GALLON
	DISTICTIS BUCCINATORIA RED TRUMPET VINE	VINE	1/5 GALLON

PROPOSED TREE LIST

**CENTRAL COAST
DRY COASTAL CALIFORNIA
DROUGHT TOLERANT PLANTINGS**

SYMBOL	BOTANICAL NAME COMMON NAME	TREE HEIGHT	QUANTITY CONTAINER SIZE
	OLEA EUROPEA 'Swan Hill' FRUITLESS OLIVE Multi-Upright	20' - 25'	3/24" BOX

NOTES

1. Plant material proposed is drought tolerant and meets the low water use requirements of the City's ordinances. The soil type as required by the City's Landscape Standards is Sorento Loam and is compatible with the selected plant types.
2. WELO Irrigation Design Compliance and Calculations are located sheet L4.
3. There are no existing trees on site. New trees planted will vary in size from 15 gallon to 24" box.
4. The Bio-retention Facility area shown, will be planted with approved bio-retention plant material for appropriate ground water recharge. See Civil Detail on sheet C2.1 and sheet L3.
5. All landscape areas will receive 3" of organic wood mulch.

BIO RETENTION PLANT LIST

Base on 800gph, 30" o.c., triangular spacing and group species smallest at the edge and tallest in the middle.

BOTANICAL	COMMON	Quantity	SIZE
Carex lasiocarpa	Santa Barbara Sedge/ Kasket Sedge	(1) 1 gallon	1'-2'
Carex obovata	Berkley Sedge	(1) 1 gallon	1'
Carex flacca	Blue Sedge	(1) 1 gallon	1'
Carex pumila	California Meadow Sedge	(1) 1 gallon	4" - 10"
Carex praeacuta	California Rill Sedge	(1) 1 gallon	1'
Juncus effusus	Common Rush	(1) 1 gallon	2'-3'
Juncus patens	Tw Blue Blue California Gray Rush	(1) 1 gallon	2'

BIO FILTERS PLANTING MIX MEDIAN



Planting with Polyethylene Sheet Pallet

RECEIVED

APR 9 2021

Planning Division



All design and/or information on these drawings are for use on this specific project and shall not be used elsewhere without the expressed written permission of Omni Design Group, Inc.

Written dimensions on these drawings shall take precedence over scaled dimensions. Contractors shall verify and be responsible for all dimensions and conditions on this job and this office shall be notified in writing of any variations from the dimensions or conditions shown in these drawings.

PROJECT NUMBER: 1247-01
DATE: MARCH 31, 2021

SHEET TITLE:
PLANTING PLAN

SHEET NUMBER:

L1

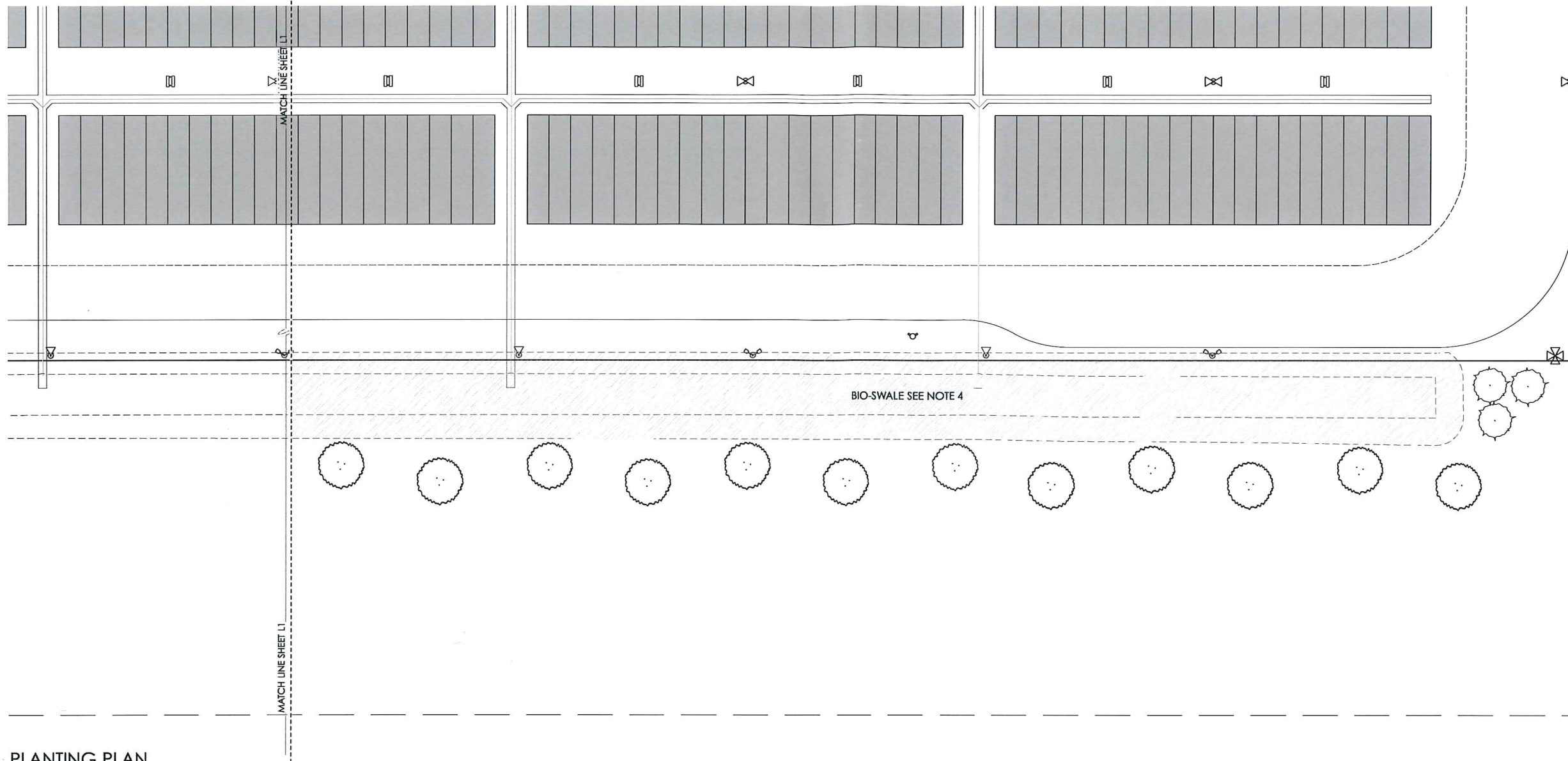

PROJECT:
Interim Container Storage Project
 1101, 1301 & 1401
 West Central Avenue
 Lompoc, California 93436

APPLICANT:
Central Coast Agriculture
 85 WEST HIGHWAY 246, #233
 BUELLTON, CALIFORNIA 93427

PLANTING PLAN

SCALE: 1" = 20'-0"



CONSTRUCTION DOCUMENTS

No.	Revision	Date	By



All design and other information on these drawings are for use on this specific project and shall not be used otherwise without the expressed written permission of Omni Design Group, Inc.

Written dimensions on these drawings shall take precedence over scaled dimensions. Contractors shall verify and be responsible for all dimensions and conditions on this job and this office shall be notified in writing of any variations from the dimensions or conditions shown in these drawings.

PROJECT NUMBER: 1247-01

DATE: MARCH 31, 2021

SHEET TITLE:

PLANTING PLAN

SHEET NUMBER:

L1.1

PROPOSED PLANT PALLET

**CENTRAL COAST
 DRY COASTAL CALIFORNIA
 DROUGHT TOLERANT PLANTINGS**

SYMBOL	BOTANICAL NAME COMMON NAME	PLANT TYPE QUANTITY	QUANTITY CONTAINER SIZE
	HETEROMELES ARBUTIFOLIA CALIFORNIA TOYON	SCREEN SHRUB	12/15 GALLON
	CEANOTHUS 'CONCHA' CALIFORNIA LILAC	MEDIUM SHRUB	3/5 GALLON
	ARCTOSTAPHYLOS HOOKERI MONTEREY MANZANITA	MEDIUM SHRUB	-/1 GALLON
	FESTUCA MARIE ATLAS FESCUE	ORNAMENTAL GRASS	-/1 GALLON
	LANTANA MONTEVIDENSIS PURPLE LANTANA	LOW SHRUB	-/1 GALLON

PROPOSED TREE LIST

**CENTRAL COAST
 DRY COASTAL CALIFORNIA
 DROUGHT TOLERANT PLANTINGS**

SYMBOL	BOTANICAL NAME COMMON NAME	TREE HEIGHT	QUANTITY CONTAINER SIZE
	OLEA EUROPEA 'Swan Hill' FRUITLESS OLIVE Multi-Upright	20' -25'	-/24" BOX

NOTES

1. Plant material proposed is drought tolerant and meets the low water use requirements of the City's ordinances. The soil type as required by the City's Landscape Standards is Sorrento Loam and is compatible with the selected plant types.
2. WELO Irrigation Design Compliance and Calculations are located sheet L4.
3. There are no existing trees on site. New trees planted will vary in size from 15 gallon to 24" box.
4. The Bio-retention Facility area shown, will be planted with approved bio-retention plant material for appropriate ground water recharge. See Civil Detail on sheet C2.1 and sheet L3.
5. All landscape areas will receive 3" of organic wood mulch.



BIO RETENTION PLANTING MEDIUM
 Base on 80/20/1, 36" o.c., V-shaped spacing and group species smallest at the edge and tallest in the middle.

BOTANICAL	COMMON	Quantity	SIZE
Carex lasiocarpa	San Joaquin Sedge/ Kestrel Sedge	(13) 1 gallon	1'-2'
Carex obovata	Barkley Sedge	(13) 1 gallon	1'
Carex fasciata	Blue Sedge	(13) 1 gallon	1'
Carex panicea	California Meadow Sedge	(13) 1 gallon	2'-10"
Carex proserpinacoides	California Field Sedge	(13) 1 gallon	1'
Juncus effusus	Common Rush	(13) 1 gallon	2'-3'
Juncus patens	1/4 Blue Six Blue California Gray Rush	(13) 1 gallon	2'

BIO FILTERING PLANTING MEDIUM



Notes:
 1. All plants shall be installed in the center of the planting area.
 2. All plants shall be installed in the center of the planting area.
 3. All plants shall be installed in the center of the planting area.
 4. All plants shall be installed in the center of the planting area.
 5. All plants shall be installed in the center of the planting area.

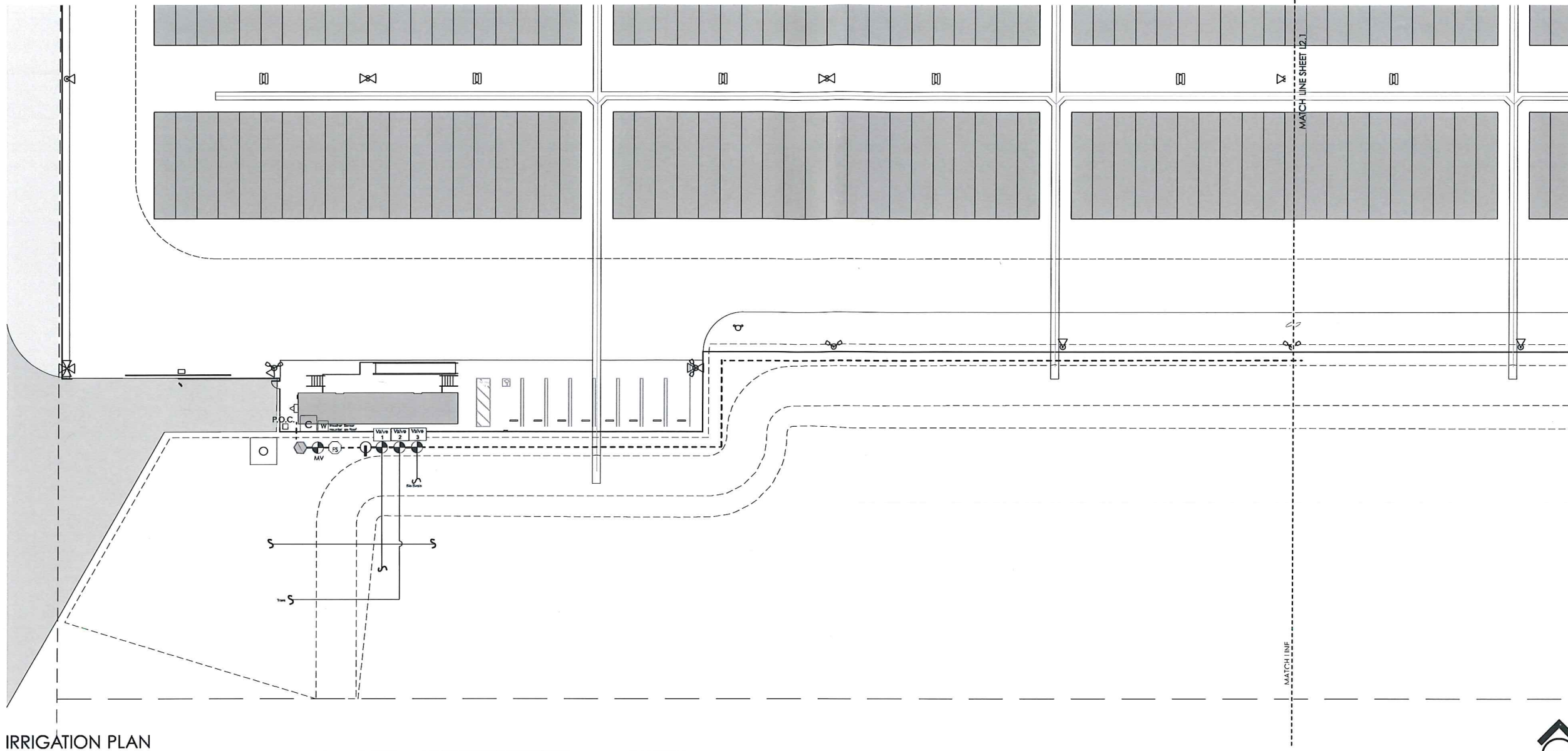

IRRIGATION PLAN

SCALE: 1" = 20'-0"

IRRIGATION LEGEND

- P.O.C. POINT OF CONNECTION - a 1 1/2" stub out from the domestic water line as shown on the plan. Verify location in the field and notify the Landscape Architect of any issues.
- New 12 station 'Hunter' ICORE W/CM module expansion automatic irrigation controller. Outdoor mount per manufacturer's specification and local codes. Use WRC Wireless 'Rain Click' climate control mounted per manufacturer's specification. See Details on Sheet L3.1
- 1 1/2" Febco 825Y Reduce Pressure Back Flow device. Install per manufacturer's details and specifications. See Details on Sheet L3.1
- Master Valve application - add a 3/4" electronic irrigation master control valve Rain Bird EFB-CP in-line series brass valves indicated on the plan. Install the Master Valve in the normally closed position. Verify Main Line fully operational. See Details on Sheet L3.1
- 3/4" Rain Bird FS-100-P Flow Sensor plastic body, install per manufacturer's specifications in. See Sheet L3.1 for additional installation specifications and details.
- 1 1/2" in-line ball valve NIBCO Ball Valve 1-1/2" Threaded Full Port T-585-66-LF (lead free) See Details on Sheet L3.1
- 1" Rain Bird Quick Coupler 3-RC: 3/4" [20/27] Rubber Cover, 1-Piece Body install per manufacturer's specifications. See Details on Sheet L3.1
- New electronic irrigation control valves Rain Bird PEB 1" Drip Valve with Rain Bird XCZ-100-PRC Kit 25 psi regulated "Y" filter. Install per manufacturer's specifications and local building codes. Place valves in the landscape planter. See Details on Sheet L3.1

Rain Bird - XFCV with heavy duty check valve - 0.9 GPH Drip Tubing XFCV-009-018-500. Install per manufacturer's specifications. Trees will be irrigated with an in-line drip ring outside the edge of the rootball of the newly planted trees. See Details on Sheet L3.1.

HYDROZONE TABLE

Station #	Size/Type	PSI	GPM
1	Low Drip	35	11
2	Low Drip Tree	35	16
3	Low Drip Bio	35	11
4	Low 1" Drip	35	11
5	Low Drip Bio	35	16
6			

WELO CERTIFICATE OF COMPLIANCE

This Landscape Plan, when installed, will comply with the City of Lompoc's Municipal Code and the State of California's Water Conservation Ordinance Water Efficient Landscape (WELO) prepared in accordance with the City water efficient landscape work sheets Appendix A and Appendix B. The WULCOLS values are in the plant legend located on Sheet L1 and are used to determine FF (plant factor) value in the calculation on Sheet L4.

The water conservation method for the new landscape plant material will have a LOW FF (Plant Factor) rating and the ETWU (estimated total water use) per year is estimated to be with in the Maximum Allowable Water Allocation (MAWA) which will be calculated for the project. Additionally, a 'Smart Controller' with a climate control weather station will be used to monitor the irrigation water and pro-rate daily water consumption to the minimum requirements for each hydrozones. All trees will be irrigated on separate systems so that once established, water can be regulated in a more efficient manner.

Tony Lee, Landscape Architect RLA#4108



PROJECT:
Interim Container Storage Project
1101, 1301 & 1401
West Central Avenue
Lompoc, California 93436

APPLICANT:
Central Coast Agriculture
85 WEST HIGHWAY 246, #233
BUELLTON, CALIFORNIA 93427

CONSTRUCTION DOCUMENTS

No.	Revision	Date	By



All designs and other information on these drawings are for use on this specific project and shall not be used otherwise without the expressed written permission of Omni Design Group, Inc.

Written dimensions on these drawings shall take precedence over scaled dimensions. Contractors shall verify and be responsible for all dimensions and conditions on this job and this office shall be notified in writing of any variations from the dimensions or conditions shown in these drawings.

PROJECT NUMBER: 1247-01
DATE: MARCH 31, 2021
SHEET TITLE:
IRRIGATION PLAN

SHEET NUMBER:

L2

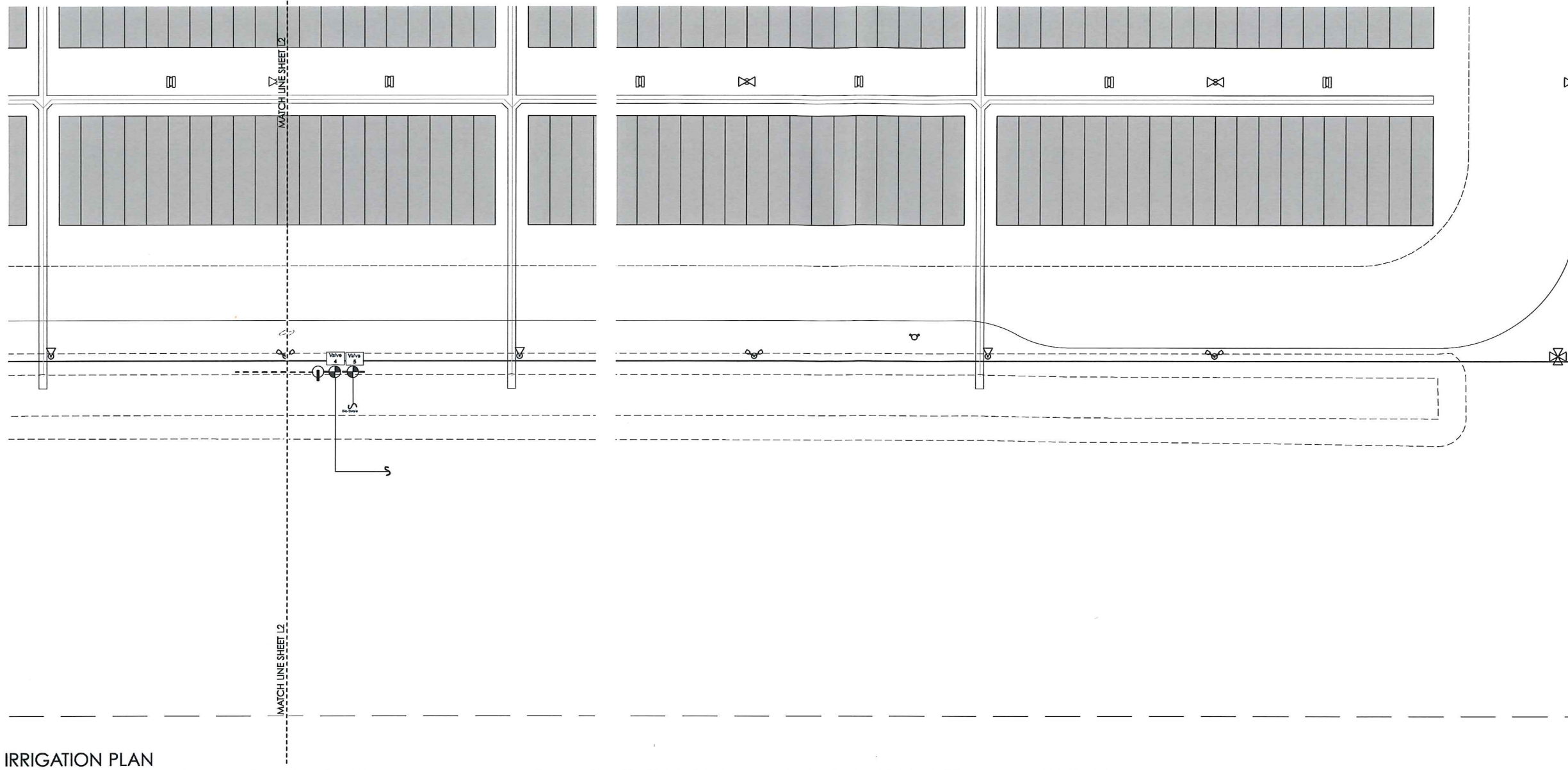

IRRIGATION PLAN

SCALE: 1" = 20'-0"

IRRIGATION LEGEND

- P.O.C.** POINT OF CONNECTION - a 1 1/2" stub out from the domestic water line as shown on the plan. Verify location in the field and notify the Landscape Architect of any issues.
- C** New 12 station 'Hunter' ICORE W/CM module expansion automatic irrigation controller. Outdoor mount per manufacturer's specification and local codes. Use WRC Wireless 'Rain Click' climate control mounted per manufacturer's specification. See Details on Sheet L3.1
- 1 1/2"** Febco 825Y Reduce Pressure Back Flow device. Install per manufacturer's details and specifications. See Details on Sheet L3.1
- MV** Master Valve application - add a 3/4" electronic irrigation master control valve Rain Bird EFB-CP in-line series brass valves indicated on the plan. Install the Master Valve in the normally closed position. Verify Main Line fully operational. See Details on Sheet L3.1
- FS** 3/4" Rain Bird FS-100-P Flow Sensor plastic body. install per manufacturer's specifications in. See Sheet L3.1 for additional installation specifications and details.
- 1 1/2"** in-line ball valve NIBCO Ball Valve 1-1/2" Threaded Full Port T-585-66-LF (lead free) See Details on Sheet L3.1
- 1"** Rain Bird Quick Coupler 3-RC-3/4" (20/27) Rubber Cover, 1-Piece Body install per manufacturer's specifications. See Details on Sheet L3.1
- New electronic irrigation control valves Rain Bird PEB 1" Drip Valve with Rain Bird XC2-100-PRC K1 25 psi regulated "Y" filter. Install per manufacturer's specifications and local building codes. Place valves in the landscape planter. See Details on Sheet L3.1



RainBird - XFCV with heavy duty check valve - 0.9 GPH Drip Tubing XFCV-009-018-500. Install per manufacturer's specifications. Trees will be irrigated with an in-line drip ring outside the edge of the rootball of the newly planted trees. See Details on Sheet L3.1.

HYDROZONE TABLE

Station #	Size/Type	PSI	GPM
1 Low	1" Drip	35	11
2 Low	Drip Tree	35	16
3 Low	Drip Blo	35	11
4 Low	1" Drip	35	11
5 Low	Drip Blo	35	16
6			

WELO CERTIFICATE OF COMPLIANCE

This Landscape Plan, when installed, will comply with the City of Lompoc's Municipal Code and the State of California's Water Conservation Ordinance 'Water Efficient Landscape' (WELC) prepared in accordance with the City water efficient landscape work sheets Appendix A and Appendix B. The WU.COLS values are in the plant legend located on Sheet L1 and are used to determine PF (plant factor) value in the calculation on Sheet L4.

The water conservation method for the new landscape plant material will have a LOW PF (Plant Factor) rating and the ETWJ (estimated total water use) per year is estimated to be with in the Maximum Allowable Water Allocation (MAWA) which will be calculated for the project. Additionally, a 'Smart Controller' with a climate control weather station will be used to monitor the irrigation water and pro-rate daily water consumption to the minimum requirements for each hydrozones. All trees will be irrigated on separate systems so that once established, water can be regulated in a more efficient manner.

Terry Lee
Terry Lee, Landscape Architect RLA#4108



PROJECT:
Interim Container Storage Project
1101, 1301 & 1401
West Central Avenue
Lompoc, California 93436

APPLICANT:
Central Coast Agriculture
85 WEST HIGHWAY 246, #233
BUELLTON, CALIFORNIA 93427

CONSTRUCTION DOCUMENTS

No.	Revision	Date	By



All designs and other information on these drawings are for use on this specific project and shall not be used otherwise without the expressed written permission of Omni Design Group, Inc.

Written dimensions on these drawings shall take precedence over scaled dimensions. Contractors shall verify and be responsible for all dimensions and conditions on this job and this office shall be notified in writing of any variations from the dimensions or conditions shown in these drawings.

PROJECT NUMBER: 1247-01
DATE: MARCH 31, 2021
SHEET TITLE:
IRRIGATION PLAN

SHEET NUMBER:

L2.1

PROJECT:
**Interim Container
Storage Project**
1101, 1301 & 1401
West Central Avenue
Lompoc, California 93436

APPLICANT:
**Central Coast
Agriculture**
85 WEST HIGHWAY 246, #233
BUELLTON, CALIFORNIA 93427

LANDSCAPE NOTES

1. THE LANDSCAPE CONTRACTOR WILL NOT SUBSTITUTE ANY PLANT MATERIAL OR LESSOR THAN SPECIFIED CONTAINER SIZE A SHOWN ON THE LANDSCAPE PLANS. THE CONTRACTOR WILL NOT ACCEPT ANY PLANT MATERIAL THAT IS OF A CONDITION THAT CAN NOT BE WARRANTED FOR 90 DAYS. PRIOR TO THE COMMENCEMENT OF WORK THE LANDSCAPE CONTRACTOR WILL NOTIFY THE UNDERGROUND SERVICE ALERT. (1-800-422-4133) OR 811.
2. ACTUAL PLANT MATERIAL QUANTITIES MAY VARY IN THE FIELD AND THE CONTRACTOR MUST NOTIFY THE LANDSCAPE ARCHITECT OF ANY DISCREPANCIES. MAINTAIN PLANT MATERIAL SPACING AS INDICATED ON THE PLAN. ALL PLANT MATERIAL SHALL BE CERTIFIED NURSERY STOCK.
3. THE LANDSCAPE CONTRACTOR WILL FURNISH ALL LABOR, MATERIALS, AND EQUIPMENT NECESSARY TO INSTALL THE LANDSCAPE AS SPECIFIED AND REQUIRED TO COMPLETE WORK AS SHOWN ON THE PLANS AND THEIR SPECIFICATIONS IN ADDITION TO LOCAL UBC AND STATE OF CALIFORNIA LICENCED LANDSCAPE CONTRACTOR STANDARDS.
4. SOIL PREPARATION AND AMENDMENTS SHALL COMPLY WITH ALL THE STATE AND LOCAL WATER EFFICIENT LANDSCAPE ORDINANCES.
5. ALL IRRIGATION WORK SHALL BE PERFORMED AHEAD OF PLANTING INCLUDING TESTING AND SHALL BE FULLY OPERATIONAL WITH THE EXCEPTION THAT ABOVE GROUND DRIP TUBING WILL BE PLACED AFTER PLANTING.
6. ALL PLANT MATERIAL WILL BE SPOTTED IN PLACE PRIOR TO PLANTING PER THE LANDSCAPE PLAN FOR THE OWNER'S REPRESENTATIVE TO REVIEW AND APPROVE. THE OWNER'S REPRESENTATIVE MAY BE ALLOWED TO ADJUST THE LOCATION OF THE PLANT MATERIAL PRIOR TO PLANTING.
7. ALL GROUND COVER SHALL BE TRIANGULARLY SPACED USING THE SPACING ON THE LANDSCAPE PLAN. ADDITIONALLY, ALL PLANT MATERIAL SHALL BE INSTALLED PER THE DETAILS ON THIS SHEET.
8. ALL LANDSCAPED AREAS WILL RECEIVE 3" ORGANIC WOOD MULCH PLACED IN A UNIFORM LAYER AROUND THE LANDSCAPE AND COVER ANY EXPOSED IRRIGATION DRIP LINES.
9. THE CONTRACTOR WILL MAINTAIN ALL LANDSCAPE AREAS IN A HEALTHY WEED FREE CONDITION FOR A PERIOD OF 90 DAYS FROM OWNER ACCEPTANCE. THE CONTRACTOR IS RESPONSIBLE FOR REPLACING ALL DAMAGED PLANT MATERIAL WITHIN THE 90 DAY MAINTENANCE PERIOD.

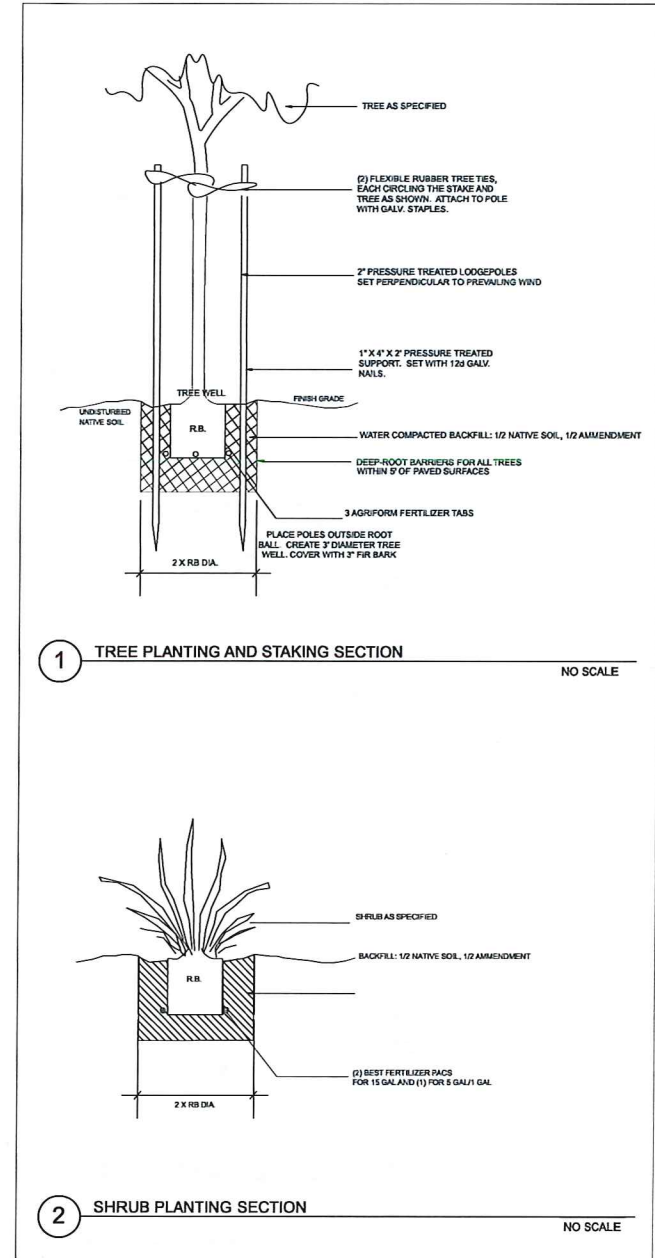
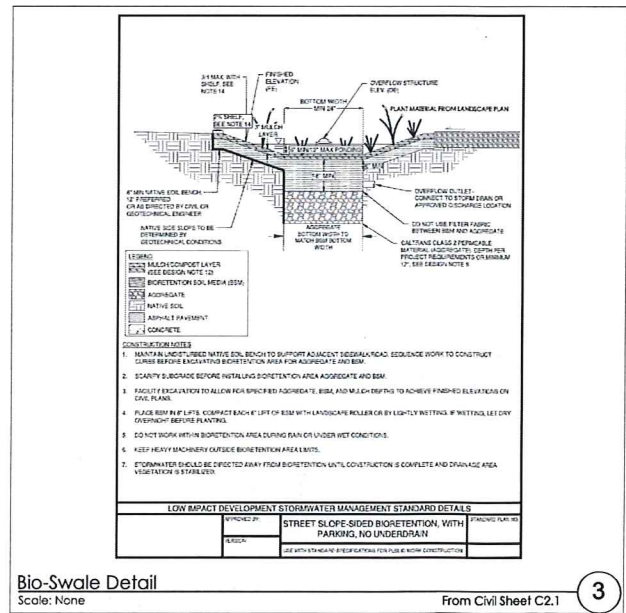

CONSTRUCTION DOCUMENTS

No.	Revision	Date	By



All designs and other information on these drawings are for use on this specific project and shall not be used otherwise without the expressed written permission of Omni Design Group, Inc.

Within dimensions on these drawings shall take precedence over scaled dimensions. Contractors shall verify and be responsible for all dimensions and conditions on this job and this office shall be notified in writing of any variations from the dimensions or conditions shown in these drawings.

PROJECT NUMBER: 1247-01
DATE: MARCH 31, 2021
SHEET TITLE:

LANDSCAPE DETAILS AND SPECIFICATIONS

SHEET NUMBER:

L3



omni
DESIGN GROUP
ARCHITECTURE
CIVIL ENGINEERING
SURVEYING
211 TANK FARMS ROAD, SUITE 100
SAN LUIS OBISPO
CALIFORNIA, 93401
PHONE: 805.844.9700
FAX: 805.844.9700

PROJECT:
**Interim Container
Storage Project**
1101, 1301 & 1401
West Central Avenue
Lompoc, California 93436

AFFILIATE:
**Central Coast
Agriculture**
85 WEST HIGHWAY 246, #233
BUELLTON, CALIFORNIA 93427

**CONSTRUCTION
DOCUMENTS**

No.	Revision	Date	By



All design and other information on these drawings are for use on this specific project and shall not be used or revised without the expressed written permission of Omni Design Group, Inc.

Written dimensions on these drawings shall take precedence over scaled dimensions. Contractors shall verify and be responsible for all dimensions and conditions on this job and this office shall be notified in writing of any variations from the dimensions or conditions shown in these drawings.

PROJECT NUMBER: 1247-01
DATE: MARCH 31, 2021

**IRRIGATION DETAILS
AND SPECIFICATIONS**

SHEET NUMBER:

L3.1

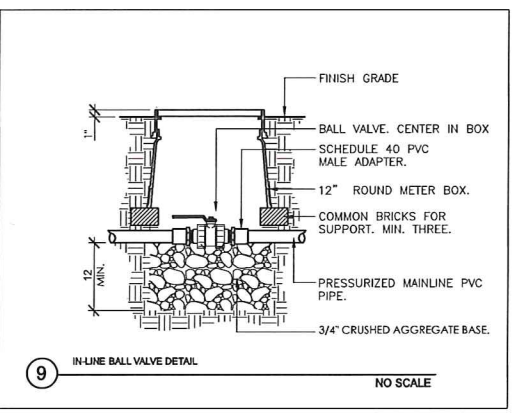
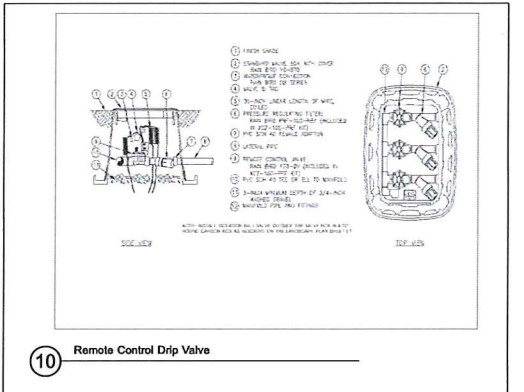
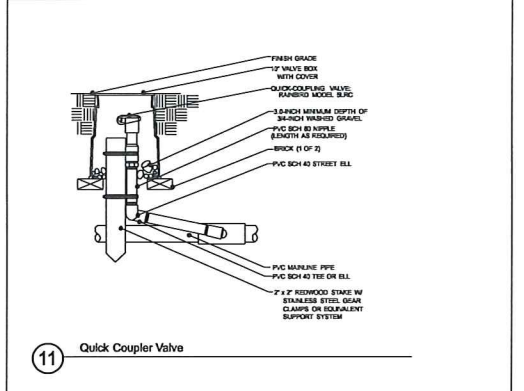
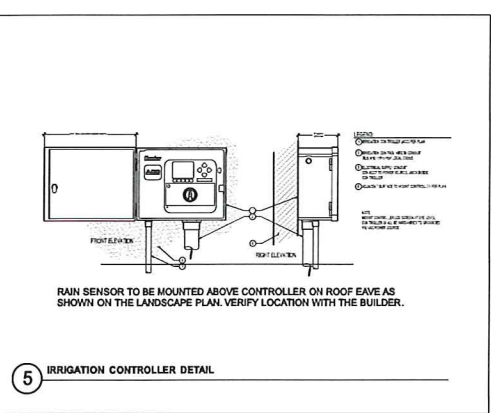
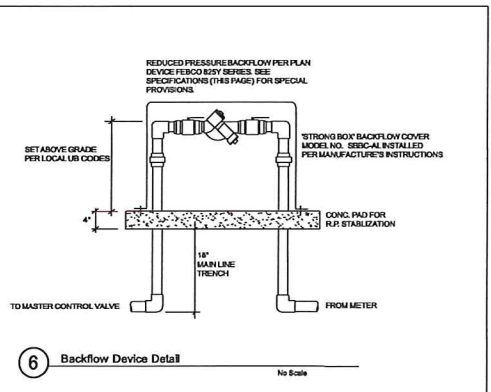
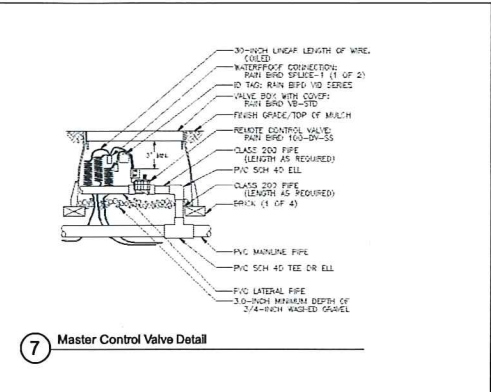
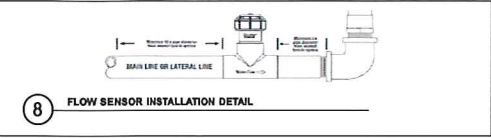
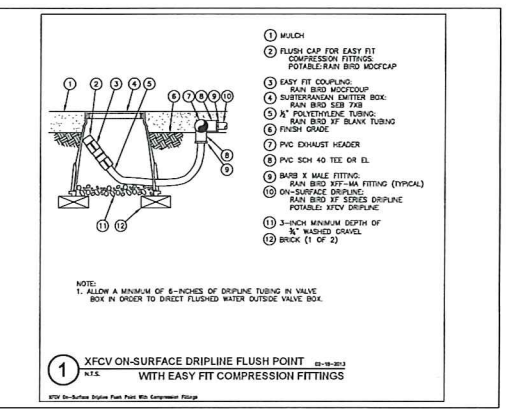
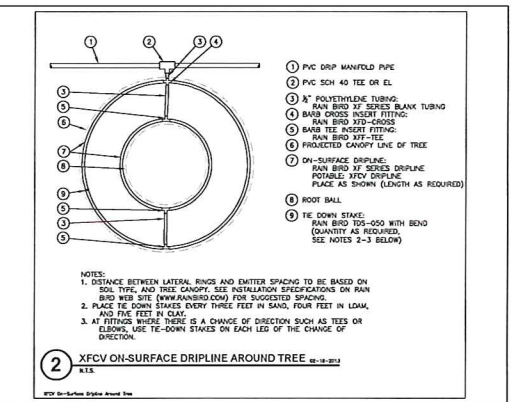
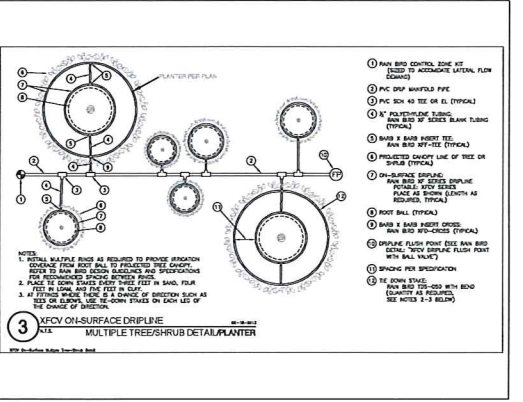
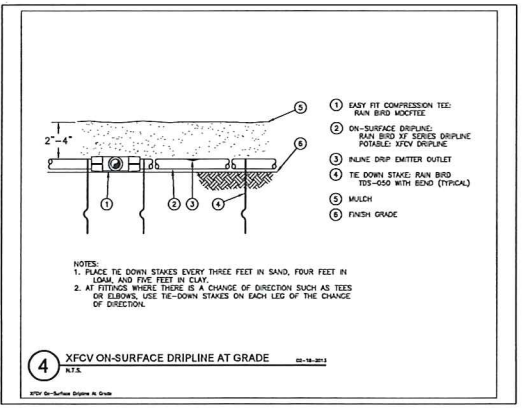

IRRIGATION NOTES

1. THE LANDSCAPE CONTRACTOR WILL NOT SUBSTITUTE ANY IRRIGATION MATERIALS OR MATERIALS OF LESSOR QUALITY THAN THOSE SPECIFIED AND SHOWN ON THE IRRIGATION PLANS. THE CONTRACTOR WILL NOT INSTALL ANY IRRIGATION EQUIPMENT THAT IS OF A CONDITION THAT CAN NOT BE WARRANTED FOR 90 DAYS. PRIOR TO THE COMMENCEMENT OF WORK THE LANDSCAPE CONTRACTOR WILL NOTIFY THE UNDERGROUND SERVICE ALERT. (1-800-422-4133) OR 811.
2. THE LANDSCAPE CONTRACTOR WILL FURNISH ALL LABOR, MATERIALS, AND EQUIPMENT NECESSARY TO INSTALL THE IRRIGATION SYSTEM AS SPECIFIED AND REQUIRED TO COMPLETE WORK AS SHOWN ON THE PLANS AND SPECIFICATIONS IN ADDITION TO LOCAL UBC AND STATE OF CALIFORNIA LICENCED LANDSCAPE CONTRATOR STANDARDS.
3. THE IRRIGATION PLAN, WHEN INSTALLED, WILL COMPLY WITH ALL THE STATE AND LOCAL WATER EFFICIENT LANDSCAPE ORDINANCES. ACTUAL LINE, VALVE AND HEAD LOCATION MAY VARY OR NEED ADJUSTMENT. THE LANDSCAPE CONTRACTOR WILL ENSURE FULL COVERAGE OF THE IRRIGATION SYSTEM AND WILL MAKE ALL APPROVED MODIFICATIONS NECESSARY TO ACCOMPLISH FULL COVERAGE OF A BALANCED SYSTEM.
4. ALL IRRIGATION WORK SHALL BE PERFORMED AHEAD OF PLANTING INCLUDING TESTING AND SHALL BE FULLY OPERATIONAL WITH THE EXCEPTION THAT ABOVE GROUND DRIP TUBING WILL BE PLACED AFTER PLANTING.
5. THE LANDSCAPE CONTRACTOR WILL COORDINATE THE NECESSARY ELECTRICAL REQUIREMENTS TO INSTALL THE IRRIGATION CONTROLLER AND ITS DEVICES. ANY WIRE SPLICING MID-RUN WILL BE CONNECTED IN A AT GRADE JUNCTION BOX WITH A 24" SERVICE LOOP.
6. THE LANDSCAPE CONTRACTOR WILL SLEEVE UNDER ALL CONCRETE SURFACES AS SHOWN ON THE IRRIGATION PLANS. ADDITIONALLY, ALL IRRIGATION EQUIPMENT WILL BE INSTALLED PER THE DETAILS ON THIS SHEET.
7. THE CONTRACTOR WILL MAINTAIN ALL IRRIGATION EQUIPMENT IN PROPER WORKING CONDITION FOR A PERIOD OF 90 DAYS FROM OWNER ACCEPTANCE. THE CONTRACTOR IS RESPONSIBLE FOR REPLACING ALL DAMAGED IRRIGATION EQUIPMENT WITHIN THE 90 DAY OPERATION PERIOD.

PROJECT:
**Interim Container
Storage Project**
1101, 1301 & 1401
West Central Avenue
Lompoc, California 93436

APPLICANT:
**Central Coast
Agriculture**
85 WEST HIGHWAY 246, #233
BUELLTON, CALIFORNIA 93427

**CONSTRUCTION
DOCUMENTS**

No.	Revision	Date	By



All designs and other information on these drawings are for use on this specific project and shall not be used otherwise without the expressed written permission of Omni Design Group, Inc.

Written dimensions on these drawings shall take precedence over scaled dimensions. Contractors shall verify and be responsible for all dimensions and conditions on this job and this office shall be notified in writing of any variations from the dimensions or conditions shown in these drawings.

PROJECT NUMBER: 1247-01

DATE: MARCH 31, 2021

SHEET TITLE:

**WELO APPENDICES
AND CALCULATIONS**

SHEET NUMBER:

L4

SECTION B WATER BUDGET CALCULATIONS

This Landscape Plan, when installed, will comply with the City of Lompoc's Municipal Code and the State of California's Water Conservation Ordinance 'Model Water Efficient Landscape' (MWEL) prepared in accordance with the State water efficient landscape work sheets Appendix A and Appendix B. The WUCOLS values are in the plant legend located on Sheet L1 and are used to determine PF (plant factor) value in the calculation below.

The water conservation method for the new landscape plant material will have a LOW to MEDIUM average PF rating and the ETWU (estimated total water use) per year is estimated to be with in the Maximum Allowable Water Allocation (MAWA) which will be calculated for the project. Additionally, a 'Smart Controller' with a climate control weather station will be used to monitor the irrigation water and pro-rate daily water consumption to the minimum requirements for each hydrozones. All trees will be irrigated on separates systems so that once established, water can be regulated in a more efficient manner.

APPENDE A AND B WORKSHEET PRELIMINARY CALCULATION

Regular Landscape Areas Total 4,840 ft²

(5) Hydrozones for (4,840 ft²) with an average Pf of 0.35 and an ET_o of 41.1 (Lompoc)
MAWA = (41.1)(0.62)(0.35 x 4840) = 43,163 gals per yr.

(MAWA) Maximum Allowed Water Allowance = 43,163 gallons per year meeting the maximum water allowed use mandated by the State of California.

ESTIMATED TOTAL WATER USE PRELIMINARY CALCULATION - ETWU Lompoc 41.1

Hydrozone No. (See Hydrozone Tables)	Plant Factor (Pf)	Irrigation Method	Irrigation Efficiency (IE)	ETAF (Pf/IE)	Total Landscape Area	ETAF x Area	Est. Total Water Use (ETWU)
#1, 3, 4, 5 LOW	.35	Drip	.81	.2835	4840	1372	34962
#2 TREES	.35	Drip	.81	.2835	0	0	0
				A = 4,840	B = 1,372		
TOTAL ETWU						34,962*	
TOTAL MAWA						43,163	

*ETWU = ET_o x 0.62 x ETAF x Area.
ETAF Calculations
Regular Landscape Areas All Landscape Areas. The average ETAF for Regular Landscape Areas must be 0.55 or below for residential areas, and 0.45 or below for non-residential areas.

Total ETAF x Area	(B)	Total ETAF x Area	(B+D)
Total Area	(A)	Total Area	(A+C)
Average ETAF	B/A	Site-wide ETAF	(A+C)/(B+D)

APPENDIX C - PART 1

CERTIFICATE OF COMPLETION

This certificate is filled out by the project applicant upon completion of the landscape project.

PART 1. PROJECT INFORMATION SHEET

Date		
Project Name		
Name of Project Applicant	Telephone No.	
	Fax No.	
Title	Email Address	
Company	Street Address	
City	State	Zip Code

Project Address and Location:

Street Address	Parcel, tract or lot number, if available.
City	Latitude/Longitude (optional)
State	Zip Code

Property Owner or his/her designee:

Name	Telephone No.
	Fax No.
Title	Email Address
Company	Street Address
City	State
	Zip Code

Property Owner

"I/we certify that I/we have received copies of all the documents within the Landscape Documentation Package and the Certificate of Completion and that it is our responsibility to see that the project is maintained in accordance with the Landscape and Irrigation Maintenance Schedule."

Property Owner Signature _____ Date _____

Please answer the questions below:

1. Date the Landscape Documentation Package was submitted to the local agency _____
2. Date the Landscape Documentation Package was approved by the local agency _____
3. Date that a copy of the Water Efficient Landscape Worksheet (including the Water Budget Calculation) was submitted to the local water purveyor _____

APPENDIX C - PART 2

CERTIFICATION OF INSTALLATION

PART 2. CERTIFICATION OF INSTALLATION ACCORDING TO THE LANDSCAPE DOCUMENTATION PACKAGE

"I/we certify that based upon periodic site observations, the work has been substantially completed in accordance with the ordinance and that the landscape planting and irrigation installation conform with the criteria and specifications of the approved Landscape Documentation Package."

Signature*	Date
Name (print)	Telephone No.
	Fax No.
Title	Email Address
License No. or Certification No.	
Company	Street Address
City	State
	Zip Code

*Signer of the landscape design plan, signer of the irrigation plan, or a licensed landscape contractor.

APPENDE D - IRRIGATION SCHEDULING

1. Provide parameters for setting the irrigation schedule on controller per MWEL Section 492.10 Schedule of Landscape And Irrigation Maintenance
2. Provide schedule of Landscape and Irrigation Maintenance per MWEL Section 492.11
3. Provide Landscape Irrigation Audit Report per MWEL Section 492.12

IRRIGATION SCHEDULE COMPLIANCE

Submit a final Irrigation Schedule for each station all of the following that apply:

1. Irrigation interval (days between irrigation);
2. Irrigation run times (hours or minutes per irrigation event to avoid runoff);
3. Number of cycle starts required for each irrigation event to avoid runoff;
4. Amount of applied water scheduled to be applied on a monthly basis;
5. Application rate setting;
6. Root depth setting;
7. Plant type setting;
8. Soil type;
9. Slope factor setting;
10. Shade factor setting; and,
11. Irrigation uniformity or efficiency setting.

VALVE TABLE

Station #	Days On	Run Time	Start Time	% Rate
1				
2				
3				
4				
5				
6				
7				
8				
9				
10				
11				
12				

HYDROZONE TABLE

Station #	Size/Type	PSI	GPM
1	Low 1" Drip	35	11
2	Low Drip Tree	35	16
3	Low Drip Bio	35	11
4	Low 1" Drip	35	11
5	Low Drip Bio	35	16
6			